

MALVERN HILLS DISTRICT COUNCIL
(OFF-STREET PARKING PLACES)
(CIVIL ENFORCEMENT)
ORDER 2013

MALVERN HILLS DISTRICT COUNCIL
(OFF-STREET PARKING PLACES)
(CIVIL ENFORCEMENT)
ORDER 2013

Malvern Hills District Council ("the Council") in exercise of its powers under Sections 32, 35 and Part IV of Schedule 9 of the Road Traffic Regulation Act 1984, as amended ("the 1984 Act") and of all other enabling powers, with the consent of Worcestershire County Council in accordance with section 39(3) of the 1984 Act and after consultation with the Chief Constable of Police in accordance with Part III of Schedule 9 to the 1984 Act hereby makes the following Order:

PART 1
GENERAL

Commencement and Citation

1. This Order shall come into operation on the 12 day of November 2013 and may be cited as the Malvern Hills District Council (Off-Street Parking Places) (Civil Enforcement) Order 2013.

Interpretation

2. In this Order, except where the context otherwise requires, the following expressions have the meanings respectively assigned to them:

"the 1984 Act" means the Road Traffic Regulation Act 1984;

"the 2004 Act" means the Traffic Management Act 2004;

"alternative approved method of payment" means cashless payments, park and phone, payment by debit or credit card facilitated by on site or remote verification by, for example, card reader or mobile phone text or phone call or decrementing card;

"authorised permit" means either a member's permit, parish council permit or staff permit issued by the Council;

"bank holiday" has the same meaning as described in the 'Banking and Financial dealings Act 1971. The first Monday of May shall be treated as if it were a Bank Holiday for the purposes of this Order;

"charging days", means those days which are as specified in Schedule 1 and at each parking place respectively;

"charging hours", means the period as specified in Schedule 1 at each parking place on all charging days;

"coach" means a chartered bus constructed to carry more than eight seated passengers in addition to the driver;

"caravan" means a non-mechanically propelled and habitable vehicle not exceeding 4.8 metres in length;

"community transport permit" means a permit issued by the Council to organisations providing community transport;

"Council" means Malvern Hills District Council or its successor authority;

"daily charge" means the charge imposed by the Council for parking in a parking place on any one day and for a specified period of time as is identified in the scale of charges specified in Column 6 of Schedule 1 to this Order and by notice at the parking place;

"disabled persons' badge" means a badge and time wheel issued by a Local Authority in accordance with the provisions of The Disabled Persons (Badges for Motor Vehicles) (England) Regulations 2000 or similar legislation for member countries of the EU.

"electric vehicle" means an vehicle that is propelled by one or more electric motors powered by a rechargeable battery;

"expiry time" is the time indicated on the pay and display ticket and is the time by which the vehicle must leave the parking place;

"HGV" means any vehicle which is constructed or adapted for use for the carriage of goods or burden of any description that has an operating weight exceeding 7.5 tonnes.

"light goods vehicle" means a vehicle which is constructed or adapted for use for the carriage of goods or burden of any description, the overall height of which does not exceed 2.40 metres and the unladen weight of which does not exceed 3050 kilograms and is not drawing a trailer;

"member's permit" means a parking permit issued to a District Councillor of the Council for use by the District Councillor in exercise of their official duties;

"motor cycle" means a mechanically propelled vehicle with fewer than 4 wheels of which the unladen weight does not exceed 410 kilograms;

"motor home" means a mechanically propelled habitable vehicle not exceeding 4.8m in length;

"owner" in relation to a vehicle means the person who is recorded as the registered keeper by the Driver and Vehicle Licensing Agency on the date on which the vehicle was parked in the parking place in question;

"parish council permit" means a parking permit issued to a parish or town council for use by a councillor or employee in exercise of their official duties;

"park" and "parked" refer to the stopping of a vehicle and it remaining at rest for some time whether or not the driver is still in the vehicle and a vehicle shall be deemed to be parked for any period in the same parking place or parking bay (as the case may be) if any part of it is below the vehicle or the vehicle's load (if any) whether or not the vehicle is moved during that period;

"park and phone" means a method of payment of the parking charge involving registration of payment by phone or electronic means and, on first use, registration of the relevant registration number of the vehicle, location of the parking place, credit or debit card details or any such other details as the Council may from time to time require which is accepted by the Council as a valid method of payment for the relevant time of use of the parking place;

"parking bay" means an area of a parking place, which is provided for the leaving of a vehicle of a class specified and indicated by markings on the surface of the parking place or signed or otherwise indicated by signs in the parking place;

"parking permit" means any or all (as the context shall require) community transport permit, disabled person's badge, member's permit, parish council permit, resident permit, season ticket, temporary permit or a permit of a type and design issued by the Council;

"parking place" means an area of land provided by the Council pursuant to Section 32(1) of the 1984 Act for the purpose of parking of vehicles and not closed (in part or in whole) by a notice erected thereon by authority of the Council;

"pay and display ticket" means a ticket issued by a ticket machine located in the parking place in which the vehicle has been parked or issued by a person nominated by the Council on payment of a charge and valid for a parking period as advertised at that parking place;

"penalty charge" and "reduced penalty charge" means a charge set by the Council under the provisions of section 77 of and schedule 9 to the 2004 Act and with the approval of the Secretary of State for Transport which is to be paid to the Council within 28 days beginning with the date of the notice, or 14 days in the case of a reduced penalty charge, following the issue of a penalty charge notice;

"plan" means the plans of parking places appended to this Order;

"public holiday" means Christmas Day, Good Friday and any other day designated by the Government as a public holiday;

"relevant position" means

- (a) in respect of a vehicle displaying a valid disabled person's badge-
 - (i) in the case of a vehicle fitted with a dashboard or fascia panel, the badge is exhibited thereon so that Part 1 (the front of the badge), is legible from outside the vehicle; or
 - (ii) in the case of a vehicle not fitted with a dashboard or fascia panel, the badge is exhibited in a conspicuous position on the vehicle so that Part 1 of the badge is legible from outside the vehicle;
- (b) in respect of a vehicle displaying a pay and display ticket or parking permit -
 - (i) the ticket or permit is exhibited on the inside surface of the windscreen or in a clearly visible position so that it is facing forwards and can be easily seen and read from the front or side of the vehicle; or
 - (ii) in the case of a vehicle that is not fitted with a transparent windscreen, the ticket or permit is exhibited on the front of the vehicle facing forwards and clearly visible;

"resident permit" means a virtual parking permit issued by the Council in accordance with Schedule 2 to this Order;

"season ticket" means a virtual parking permit issued by the Council in accordance with Schedule 3 to this Order;

"staff permit" means a parking permit issued by the Council to an employee, worker, contractor, or other such person performing services to the Council from time to time;

"ticket machine" means an apparatus of a type designed to indicate the time by a clock and to issue parking tickets which show that a payment has been made of an amount or for a period specified thereon and which specify the date and, either the time of such payment, or the expiry time of the parking period for which payment has been made;

"trailer" refer to an object or vehicle being drawn by another vehicle not including a caravan;

"vehicle" includes any motor car, motor cycle, coach, goods vehicle or other mechanically propelled automobile.

"virtual parking permit" means an electronic record of parking ticket, permit or dispensation issued and confirmed by the Council to exempt a vehicle from a restriction in the provisions of this order, under the terms applicable at the time of issue. A virtual parking permit may be obtained by any of the methods provided from time to time by the Council and to be valid must be registered on an account in an electronic database approved by the Council with an indication that the permit has been issued and validated in accordance with Council procedures.

"wait" and "waiting" refer to the stopping of a vehicle and it remaining at rest for some time whether or not the driver is still in the vehicle; "wait" and "waiting" apply as for "park" and "parked"

3. Except where the context requires otherwise, any reference in this Order to a numbered Article shall be construed as a reference to the Article bearing that number in this Order and any reference in this Order to the schedule is a reference to schedules 1 and 2 to this order, otherwise they shall be referred to independently as Schedule 1 or Schedule 2 etc.
4. Any reference in this Order to any enactment shall be construed as a reference to that enactment as amended, applied, consolidated, re-enacted by or as having effect by virtue of any subsequent enactment and to any subordinate legislation or by-law made under that enactment.
5. Unless the context otherwise requires, words denoting the singular shall include the plural and vice versa and words denoting the persons shall include either gender, bodies corporate, unincorporated associations and partnerships.
6. The Interpretation Act 1978 shall apply for the interpretation of this Order as it applies for the interpretation of an Act of Parliament.

PART 2

DESIGNATION AND USE OF PARKING PLACES

Designation

7. Each area of land or building named and specified by the Plans in Schedule 2 to this Order may be used, subject to the provisions of this Order, as a place to park vehicles of such classes, in such positions, on such days, during such hours, for such periods as are advertised at each parking place and on payment of such charges as stated in Schedule 1 to this Order and as advertised at the parking place.

Class and position of vehicle

8. Where by notice at a parking place, the parking place, or any parking bay within the parking place, is described as available for vehicles of a specified class or vehicles to be parked in a specified location, no person shall cause or permit a vehicle to be parked in that parking place or in any parking bay within the parking place,
 - (i) unless it is of the specified class; or is;
 - (ii) in a position other than that specified; or
 - (iii) for a purpose other than provided for in this Order.

Classes of vehicle

9. No person shall cause or permit a vehicle to be parked in a parking bay unless it is a class specifically prescribed in column 2 of Schedule 1 or advertised at the parking place.

Position of vehicle

10. A driver of a vehicle (other than a HGV or a coach not parking in a coach bay) shall ensure that the vehicle or anything drawn by it is not parked beyond the parking bay markings and shall not permit it to wait in that parking place unless it is so positioned.
11. A driver of a HGV or a coach not parking in a coach bay shall ensure that the vehicle is positioned so that it does not obstruct or potentially obstruct other vehicles using the parking place, the free flow of traffic circulating within the parking place or the entrances to and exits from the parking place.

Disabled person's parking bays

12. No person shall cause or permit a vehicle to be parked in a parking bay marked for disabled persons unless the vehicle displays a valid disabled person's badge in the

relevant position and immediately before or immediately after the act of parking the vehicle has been or is about to be used by the person(s) in respect of whom the disabled person's badge has been issued.

Electric vehicle parking bays

13. No person shall cause or permit a vehicle to be parked in a parking bay marked for the charging of electric vehicles unless it is an electric vehicle.

Motorcycle parking bays

14. No person shall cause or permit a vehicle to park in a parking bay marked for motor cycles unless the vehicle is a motorcycle.

Motor homes, caravans and trailers

15. Motor homes, caravans and trailers are only permitted to wait in accordance with Schedule 1 of this Order and are liable to a parking charge.

Hours of operation and maximum period of stay

16. A parking place or in any parking bay within the parking place as described in Schedule 1 as being in operation on specified days, during specified hours or for a maximum period of stay, no person shall cause or permit a vehicle to be parked in that parking place or in any parking bay within the parking place on any day, during such hours or for any period other or longer than those specified.

Period of no return

17. Where specified in Schedule 1 and by notice at the parking place, a parking place is described as having a period within which a vehicle may not return, no person shall cause or permit a vehicle to be parked again in that parking place on any day, during such hours within which the vehicle is excluded from waiting in the parking place.

Power to close or suspend parking places

18. Nothing in this Order shall prevent the Council by notice, sign or barrier displayed or erected in a parking place:
 - (i) from closing a parking place or any part thereof for any period; or

- (ii) from setting aside a parking place or any part or parts thereof on all days or on certain days or during certain parts of days for use only by particular vehicles or organisations.
19. Any person closing or suspending the use of a parking place or any part thereof shall thereupon place or cause to be placed in or adjacent to that parking place or that part thereof a notice or traffic sign indicating that of that parking place or that part thereof is closed or the use is suspended and that parking by vehicles is prohibited.
20. No person shall cause or permit a vehicle to be parked in a parking place or any part thereof during such periods that the parking place or that part thereof is closed or the use is suspended or during such period as there is in or adjacent thereto a notice or traffic sign indicating the closure or suspension placed by or on behalf of the Council.

Sale of Goods

21. No person shall in a parking place without the express written permission of the Council, use a vehicle, in connection with the sale of any article, including the vehicle itself, to any person in or near the parking place or in connection with the selling or offering for hire of skill or services in any other capacity.

Parked with engine running

22. No person shall in a parking place continue to run the engine when the vehicle is in the parking space and shall not start the engine except when about to change the position of the vehicle in or to depart from the parking place.

Parked causing an obstruction or potential obstruction

23. No person shall in a parking place park the vehicle in such a manner or place where it causes an obstruction or potential obstruction to any other users of the parking place.

PART 3 CHARGES FOR PARKING

Pay and Display Parking Places

24. The person in charge of a vehicle, upon parking the vehicle in a parking bay, shall immediately

- (i) arrange for the purchase of a pay and display ticket from a ticket machine situated at that parking place at the level of daily charge and for the period required in accordance with the scale of charges as stated in Column 6 of Schedule 1 to this Order and as advertised at the parking place.

or

- (ii) make arrangements to pay the appropriate fee through an alternative approved method of payment such as park and phone at the level of charge and for the period required in accordance with the scale of charges as stated in Column 6 of Schedule 1 to this Order and as advertised at the parking place.

Payment

25. No person shall cause or permit any vehicle to be parked in a parking place without arranging for the appropriate charge (if any) to be paid in accordance with the scale of current charges as specified in column 6 of Schedule 1 to this Order and as advertised at the parking place.

Means of payment

26. The charges referred to in the preceding Article shall be payable in the manner as advertised at that parking place.

Display of ticket

27. Save for payment by an alternative approved method of payment, once a vehicle has been parked within a parking place that is liable to a parking charge the person in charge of the vehicle shall ensure that:
- (i) a valid pay and display ticket has been obtained to cover the entire period that the vehicle is parked in the parking place, and
 - (ii) the valid pay and display ticket is displayed in the relevant position on the vehicle in respect of which it was issued at all times the vehicle is parked.

Validity of pay and display tickets

28. A pay and display ticket is not transferable from one vehicle to another and on transfer the pay and display ticket ceases to be valid.

29. A pay and display ticket is valid in the parking place in which it was issued and in any other pay and display car park managed by the Council with the same time limits as the car park of issue.

Expiry of parking period

30. The expiry of the period for which the appropriate charge has been paid shall be
- (i) where a pay and display ticket has been purchased, when the time is later than the expiry time shown on the pay and display ticket displayed, or
 - (ii) where an alternative approved method of payment has been used, when the period for which payment has been made and recorded has been exceeded.

No pay and display ticket displayed

31. If at any time while a vehicle is parked in a parking place, no pay and display ticket is displayed on that vehicle in the relevant position and in accordance with the provisions of this Order, it shall be deemed that the charge has not been paid. Where a virtual parking permit has been obtained as an alternative to a pay and display ticket and remains valid, any requirement for the pay and display ticket to be displayed on the vehicle to which it relates shall not apply.
32. If at the time when a vehicle is parked during the charging hours in a parking place and the nearest ticket machine in that parking place is out of order, then a ticket shall be obtained from another ticket machine within the same parking place (where provided) or as directed in the parking place.
33. Where no valid pay and display ticket can be obtained from a ticket machine within a parking place, a vehicle may be parked in a parking place but may not be parked for longer than the maximum period of parking in that parking place as set out in column 4 of Schedule 1 and advertised at the parking place.

Parking permits

34. The Council may issue a resident permit in accordance with the provisions of Schedule 2.

35. The Council may issue a 'season ticket in accordance with the provisions of Schedule 3.
36. The Council may issue a community transport permit in accordance with the Council's Community Transport Policy to a member of the Worcestershire Concessionary Travel Schedule or to any scheme from time to time in place or at the Council's discretion to those organisations providing community transport in the Council's administrative area.
37. The Council may issue member's permits for District Councillors to park in any parking place subject to such rules as the Council may impose from time to time but otherwise in accordance with this Order.
38. The Council may issue 1 parish council permit to each parish or town council in the Council's administrative area for councillors or employees of the town or parish council to park in any parking place subject to such rules as the Council may impose from time to time but otherwise in accordance with this Order.
39. The Council may issue staff permits to park in any parking place subject to such rules as the Council may impose from time to time but otherwise in accordance with this Order.
40. A parking permit as set out in Articles 35 – 42 is only valid in the parking places(s) in respect of which it was issued, for the vehicle in respect of which it was issued and up to the date of expiry shown on the parking permit or virtual parking permit as the case may be.
41. A driver who has a parking permit shall abide by the terms stipulated by the Council for use of the parking permit.
42. Nothing in this Order shall prevent the Council from exercising its discretion to issue a temporary permit to an individual or organisation to park in a specific parking place for a defined period of time.

Display of parking permit

43. A parking permit shall be displayed in the relevant position on the vehicle in respect of which it was issued at all times during which the vehicle is parked in the parking place.
44. Where a virtual parking permit has been obtained as an alternative to a pay and display ticket and remains valid, any requirement in this Order for the pay and display ticket to be displayed on the vehicle to which it relates shall not apply.

Replacement of parking permits

45. Damaged or lost parking permits will be replaced on application to the Council and on payment of an administration fee in accordance with Council policies. The damaged or lost parking permit will then become immediately invalid.

Surrender and refunds

46. A parking permit remains the property of the Council and must be surrendered on request. In such instances any refund of fee paid will be provided in accordance with the Council policy in place at that time.
47. The holder of a parking permit may, on surrendering the parking permit, be entitled to a refund based upon the Council policy in place at that time.

Restriction on removal

48. When a pay and display ticket or parking permit has been exhibited on a vehicle in the relevant position no person shall remove the pay and display ticket or parking permit from the vehicle until the vehicle is removed from the parking place.

PART 4 EXEMPTIONS

Exemption from charge

49. No charge shall be payable in respect of;
 - (i) a motorcycle unless parked in a parking bay other than marked for motorcycles; or
 - (ii) a vehicle parked displaying in a relevant position a parking permit valid for that parking place; or

- (iii) emergency service vehicles in the course of undertaking emergency duties; or
- (iv) a vehicle parked displaying in a relevant position a disabled persons badge.

Absence of Ticket machine

50. If at the time when a vehicle is parked in a parking place during the charging hours there is no ticket machine at the parking place, or all the ticket machines at that parking place carry notices placed upon them by a person duly authorised by the Council indicating that they are out of order, the driver of that vehicle shall be exempt from purchasing a pay and display ticket.

Payment by alternative approved method of payment

51. Where arrangements to pay the charge have been made through an alternative approved method of payment and no pay and display ticket is produced by following the process, the driver of a vehicle shall be exempt from the requirement to display such a ticket.

PART 5

RELOCATION, REMOVAL, CLAMPING AND DISPOSAL OF VEHICLES

Emergencies

52. A person authorised by the Council or a police officer in uniform may, using such measures as are appropriate, move or cause to be moved in the case of an emergency to any place he/she thinks fit, any vehicle parked in a parking place.

Contraventions in suspended parking place

53. A person authorised by the Council may, using such measures as are appropriate, move or cause to be moved to any place he/she thinks fit, any vehicle parked in a parking place which has been closed or suspended in whole or in part by the Council and the cost of movement or removal and safe keeping shall be the liability of the owner of the vehicle.

Safe keeping

54. Any person removing a vehicle from a parking place under the provisions of this Order shall make such arrangements as may be reasonably necessary to provide for the safe keeping of the vehicle.

Disposal of vehicles abandoned in parking places

55. The Council may sell or otherwise dispose of, in accordance with current legislation, a vehicle which has been, or could at any time be, removed from a parking place if the vehicle appears to have been abandoned and will be dealt with under the abandoned vehicle legislation.

PART 6

CONTRAVENTION AND PENALTY CHARGE

Contravention

56. Save for the provisions in Part 7, if a vehicle is parked in a parking place without complying with the requirements of this Order, a contravention shall have occurred and a penalty charge shall be payable as set out in Schedule 4 to this Order.

Restriction on removal of notices

57. Any notice fixed to a vehicle in accordance with this Order shall not be removed or interfered with except by or under the authority of:
- (i) the owner, or person in charge of, the vehicle; or
 - (ii) the Council.

Indications as Evidence

58. The particulars given in any notice served on a vehicle in accordance with the provisions of this Order shall be treated as evidence in any proceedings relating to failure to pay the penalty charge.

PART 7

LIABILITY AND OTHER PROVISIONS

Liability

59. The Council accepts no liability for the loss or damage to vehicles or other property left in any of the parking places to which this Order applies save for that arising from the negligence of the Council.

Validity

60. If a Court, the Department for Transport, the Traffic Penalty Tribunal or the Traffic Enforcement Centre declares any part of this Order to be invalid or unenforceable, such declaration shall not invalidate the remainder of the Order.

Driving within a parking place

61. Where in a parking place signs are erected or surface markings are laid for the purpose of
- (i) indicating the entrance to or exit from the parking place, or
 - (ii) indicating that a vehicle using the parking place shall proceed in a specified direction within the parking place,
- any person who drives or permits to be driven any vehicle
- (i) so that it enters the parking place otherwise than by an entrance or leaves the parking place otherwise than by an exit, so indicated, or
 - (ii) in a direction other than so specified
- shall be liable to prosecution.
62. Any person who, without the permission of a person authorised by the Council in that behalf, drives or permits to be driven any vehicle in a parking place for any purpose other than the purpose of leaving that vehicle in the parking place in accordance with the provisions of this Order or for the purpose of departing from the parking place shall be liable to prosecution.

Wilful damage

63. Any person who with intent to defraud interferes with a ticket machine or operates or attempts to operate it by the insertion of objects other than undamaged and unaltered coins of legal tender and of the appropriate denomination, shall be liable to prosecution.

Domestic purposes

64. Any person who uses any part of the parking place or any vehicle parked in a parking place
- (i) for sleeping or camping or cooking, or
 - (ii) for the purpose of servicing or washing any vehicle or part thereof other than is reasonably necessary to enable the vehicle to depart from the parking place,

shall be liable to prosecution.

Behaviour

65. Any person who wilfully sounds any horn or any other similar instrument on a vehicle except when about to change the position of the vehicle in or to depart from the parking place shall be liable to prosecution.
66. Any person who in a parking place shouts or otherwise makes any loud noise to the disturbance or annoyance of users of the parking place or residents or premises in the neighbourhood shall be liable to prosecution.
67. Any person who in a parking place uses any threatening, abusive or insulting language, gesture or conduct with intent to put any person in fear or so as to occasion a breach of the peace or whereby a breach of the peace is likely to be occasioned shall be liable to prosecution.

Other activities

68. Any person who in a parking place
- (i) erects or causes or permits to be erected any tent, booth, stand, building or other structure without the written consent of the Council, or
 - (ii) lights or causes to be lit any fire,
 - (iii) causes wilful or deliberate damage to the fabric of the parking place
 - (iv) cycles or skateboards
 - (v) takes part in or undertakes ball games or sporting activities
- shall be liable to prosecution.

PART 8

REVOCATIONS

Revocations

69. The following Order made by the Council and all their amendments and any other Orders and Regulations of whatever nature relating to off-street parking places specified in the Schedules within the area of the Council made before the introduction of this Order are hereby revoked:

The Malvern Hills District Council (Off Street Parking Places) Order 2013

EXECUTED as a Deed by affixing the COMMON SEAL
of Malvern Hills District Council
in the presence of

John R Williams

Dated this *11 November 2015*



No. 1804

MALVERN HILLS DISTRICT COUNCIL
(OFF-STREET PARKING PLACES)
(CIVIL ENFORCEMENT) ORDER 2013

SCHEDULE 1

1	2	3	4	5	6
Name of parking place and Plan number	Permitted classes of vehicles	Days and hours of operation of parking place	Maximum waiting time	No return within	Scale of Charges
Belle Vue Terrace (1)	Motor cars Electric vehicles Light goods vehicles Motor cycles	All days between 00:00 – 18:00	2 hours	2 hours	Up to 1 hour £0.50 Up to 2 hours £1.40 Motor cycles parked in a motor cycle bay – no charge Vehicles displaying a valid disabled person's badge in the relevant position – no charge
Belle Vue Terrace (1)	Motor cars Electric vehicles Light goods vehicles Motor cycles	All days between 18:00 – 00:00	6 hours	No restriction	Up to 1 hour £0.50 Up to 2 hours £1.40 Between 18:00 – 00:00 £1.50 Motor cycles parked in a motor cycle bay – no charge Vehicles displaying a valid disabled person's badge in the relevant position – no charge
Brunel House (2)	Motor cars Electric vehicles Light goods vehicles	Monday – Friday between 08:00 – 19:30 excluding bank holidays and public holidays	11.5 hours	No restriction	Not applicable Authorised permit holders only

1	2	3	4	5	6
Name of parking place and plan number	Permitted classes of vehicles	Days and hours of operation of parking place	Maximum waiting time	No return within	Scale of Charges
Brunel House (2)	Motor cars Electric vehicles Light goods vehicles Motor cycles	Monday – Thursday 19:30 to 08:00 the following day	12.5 hours	No restriction	Up to 1 hour £0.50 Up to 2 hours £1.00 Up to 4 hours £2.00 Between 4 – 24 hours £3.00 Between 19:30 – 00:00 £1.50 Motor cycles parked in a motor cycle bay – no charge Vehicles displaying a valid disabled person's badge in the relevant position – no charge
Brunel House (2)	Motor cars Electric vehicles Light goods vehicles Motor cycles	Monday between 00:00 – 08:00 Friday from 19:30 – 00:00	24 hours	No restriction	Up to 1 hour £0.50 Up to 2 hours £1.00 Up to 4 hours £2.00 Between 4 – 24 hours £3.00 Between 19:30 – 00:00 £1.50 Motor cycles parked in a motor cycle bay – no charge Vehicles displaying a valid disabled person's badge in the relevant position – no charge
Brunel House (2)	Motor cars Electric vehicles Light goods vehicles Motor cycles	Saturday, Sunday, bank holiday and public holiday All day and all hours	24 hours	No restriction	Up to 1 hour £0.50 Up to 2 hours £1.00 Up to 4 hours £2.00 Between 4 – 24 hours £3.00 Between 18:00 – 00:00 £1.50 Motor cycles parked in a motor cycle bay – no charge Vehicles displaying a valid disabled person's badge in the relevant position – no charge

1	2	3	4	5	6
Name of parking place and Plan number	Permitted classes of vehicles	Days and hours of operation of parking place	Maximum waiting time	No return within	Scale of Charges
Council House (3)	Motor cars Electric vehicles Light goods vehicles Motor cycles	Monday – Friday between 08:00 – 19:30 excluding bank holidays and public holidays	11.5 hours	No restriction	Not applicable. Authorised permit holders only
Council House (3)	Motor cars Electric vehicles Light goods vehicles Motor cycles	Monday – Thursday 19:30 to 08:00 the following day	12.5 hours	No restriction	Up to 1 hour £0.50 Up to 2 hours £1.00 Up to 4 hours £2.00 Between 4 – 12.5 hours £3.00 Between 19:30 – 00:00 £1.50 Motor cycles parked in a motor cycle bay – no charge Vehicles displaying a valid disabled person's badge in the relevant position – no charge
Council House (3)	Motor cars Electric vehicles Light goods vehicles Motor cycles	Monday between 00:00 – 08:00 Friday from 19:30 – 00:00	24 hours	No restriction	Up to 1 hour £0.50 Up to 2 hours £1.00 Up to 4 hours £2.00 Between 4 – 24 hours £3.00 Between 19:30 – 00:00 £1.50 Motor cycles parked in a motor cycle bay – no charge Vehicles displaying a valid disabled person's badge in the relevant position – no charge

1	2	3	4	5	6
Name of parking place and Plan number	Permitted classes of vehicles	Days and hours of operation of parking place	Maximum waiting time	No return within	Scale of Charges
Council House (3)	Motor cars Electric vehicles Light goods vehicles Motor cycles	Saturday, Sunday, bank holiday and public holiday All day and all hours	24 hours	No restriction	Up to 1 hour £0.50 Up to 2 hours £1.00 Up to 4 hours £2.00 Between 4 – 24 hours £3.00 Between 18:00 – 00:00 £1.50 Motor cycles parked in a motor cycle bay – no charge Vehicles displaying a valid disabled person's badge in the relevant position – no charge
Edith Walk (4)	Motor cars Electric vehicles Motor cycles Light goods vehicles	All days between 00:00 – 18:00	2 hours	2 hours	Up to 1 hour £0.50 Up to 2 hours £1.40 Motor cycles parked in a motor cycle bay – no charge Vehicles displaying a valid disabled person's badge in the relevant position – no charge
Edith Walk (4)	Motor cars Electric vehicles Light goods vehicles Motor cycles	All days between 18:00 – 00:00	6 hours	No restriction	Up to 1 hour £0.50 Up to 2 hours £1.40 Between 18:00 – 00:00 £1.50 Motor cycles parked in a motor cycle bay – no charge Vehicles displaying a valid disabled person's badge in the relevant position – no charge

1	2	3	4	5	6
Name of parking place and Plan number	Permitted classes of vehicles	Days and hours of operation of parking place	Maximum waiting time	No return within	Scale of Charges
Geraldine Road (5)	Motor cars Electric vehicles Light goods vehicles Motor cycles	All days between 00:00 – 18:00	2 hours	2 hours	Up to 1 hour £0.50 Up to 2 hours £1.00 Motor cycles parked in a motor cycle bay – no charge Vehicles displaying a valid disabled person's badge in the relevant position – no charge
Geraldine Road (5)	Motor cars Electric vehicles Light goods vehicles Motor cycles	All days between 18:00 – 00:00	6 hours	No restriction	Up to 1 hour £0.50 Up to 2 hours £1.00 Between 18:00 – 00:00 £1.50 Motor cycles parked in a motor cycle bay – no charge Vehicles displaying a valid disabled person's badge in the relevant position – no charge
Grange Road North (6)	Motor cars Electric vehicles Light goods vehicles Motor cycles	All days between 18:00 – 00:00	2 hours	2 hours	Up to 1 hour £0.50 Up to 2 hours £1.40 Between 18:00 – 00:00 £1.50 Motor cycles parked in a motor cycle bay – no charge Vehicles displaying a valid disabled person's badge in the relevant position – no charge
Grange Road North (6)	Motor cars Electric vehicles Light goods vehicles Motor cycles	All days between 18:00 – 00:00	6 hours	No restriction	Up to 1 hour £0.50 Up to 2 hours £1.40 Between 18:00 – 00:00 £1.50 Motor cycles parked in a motor cycle bay – no charge Vehicles displaying a valid disabled person's badge in the relevant position – no charge

1	2	3	4	5	6
Name of parking place and Plan number	Permitted classes of vehicles	Days and hours of operation of parking place	Maximum waiting time	No return within	Scale of Charges
Grange Road South (7)	Motor cars Electric vehicles Light goods vehicles Motor cycles	All days between 00:00 – 18:00	2 hours	2 hours	Up to 1 hour £0.50 Up to 2 hours £1.40 Motor cycles parked in a motor cycle bay – no charge Vehicles displaying a valid disabled person's badge in the relevant position – no charge
Grange Road South (7)	Motor cars Electric vehicles Motor cycles Light goods vehicles	All days between 18:00 – 00:00	6 hours	No restriction	Up to 1 hour £0.50 Up to 2 hours £1.40 Between 18:00 – 00:00 £1.50 Motor cycles parked in a motor cycle bay – no charge Vehicles displaying a valid disabled person's badge in the relevant position – no charge
Hanley Road (8)	Motor cars Electric vehicles Light goods vehicles Motor cycles Caravans Motor homes Coaches HGVs	All days, all hours	24 hours	No restriction	Up to 1 hour £0.50 Up to 2 hours £1.00 Up to 4 hours £2.00 Between 4 – 24 hours £3.00 Between 18:00 – 00:00 £1.50 £9.00 for a 7 day ticket Coaches only: £0.10 if parked in a coach bay otherwise £7.00 HGVs only: £10.00 Motor cycles parked in a motor cycle bay – no charge Vehicles displaying a valid disabled person's badge in the relevant position – no charge

1	2	3	4	5	6
Name of parking place and plan number	Permitted classes of vehicles	Days and hours of operation of parking place	Maximum waiting time	No return within	Scale of Charges
Link Top (9)	Motor cars Electric vehicles Light goods vehicles Motor cycles	All days, all hours	24 hours	No restriction	None
New Street (10)	Motor cars Electric vehicles Light goods vehicles Motor cycles	All days, all hours	24 hours	No restriction	Up to 1 hour £0.50 Up to 2 hours £1.00 Up to 4 hours £2.00 Between 4 – 24 hours £3.00 Between 18:00 – 00:00 £1.50 £9.00 for a 7 day ticket Motor cycles parked in a motor cycle bay – no charge Vehicles displaying a valid disabled person's badge in the relevant position – no charge
Newtown Road (11)	Motor cars Electric vehicles Light goods vehicles Motor cycles	All days, all hours	24 hours	No restriction	None

1	2	3	4	5	6
Name of parking place and plan number	Permitted classes of vehicles	Days and hours of operation of parking place	Maximum waiting time	No return within	Scale of Charges
Priory Road North (12)	Motor cars Electric vehicles Light goods vehicles Motor cycles	All days, all hours	24 hours	No restriction	Up to 1 hour £0.50 Up to 2 hours £1.00 Up to 4 hours £2.00 Between 4 – 24 hours £3.00 Between 18:00 – 00:00 £1.50 £9.00 for a 7 day ticket Motor cycles parked in a motor cycle bay – no charge Vehicles displaying a valid disabled person's badge in the relevant position – no charge
Priory Road South (13)	Motor cars Electric vehicles Light goods vehicles Motor homes Coaches Motor cycles	All days, all hours	24 hours	No restriction	Up to 1 hour £0.50 Up to 2 hours £1.00 Up to 4 hours £2.00 Between 4 – 24 hours £3.00 Between 18:00 – 00:00 £1.50 £9.00 for a 7 day ticket Coaches only: £0.10 if parked in a coach bay otherwise £7.00 Motor cycles parked in a motor cycle bay – no charge Vehicles displaying a valid disabled person's badge in the relevant position – no charge
Teme Street (14)	Motor cars Electric vehicles Light goods vehicles Motor cycles	All days, all hours	24 hours	No restriction	Up to 1 hour £0.50 Up to 2 hours £1.00 Up to 4 hours £2.00 Between 4 – 24 hours £3.00 Between 18:00 – 00:00 £1.50 £9.00 for a 7 day ticket

1	2	3	4	5	6
Name of parking place and plan number	Permitted classes of vehicles	Days and hours of operation of parking place	Maximum waiting time	No return within	Scale of Charges
Victoria Road (15)	Motor cars Electric vehicles Light goods vehicles Motor cycles	All days, all hours	24 hours	No restriction	Up to 1 hour £0.50 Up to 2 hours £1.00 Up to 4 hours £2.00 Between 4 – 24 hours £3.00 Between 18:00 – 00:00 £1.50 £9.00 for a 7 day ticket Motor cycles parked in a motor cycle bay – no charge Vehicles displaying a valid disabled person's badge in the relevant position – no charge

SCHEDULE 2

RESIDENT PERMITS

1. The Council may issue a resident permit and a time wheel to an eligible person upon payment of a prescribed fee ("the holder").
2. Provided the holder parks an identified vehicle in accordance with this Schedule, the identified vehicle may wait:
 - a. in a parking place for a period of not more than 2 hours in any 4 hour period; and
 - b. in New Street, Priory Road North, Priory Road South, Victoria Road, Hanley Road and Teme Street parking places for a maximum period of 6 hours between 18:00 – 00:00; and
 - c. in Brunel House and Council House parking places for a maximum of 4.5 hours between 19:30 – 00:00 on Monday to Friday; and
 - d. in Brunel House and Council House parking places for a maximum period of 6 hours between 18:00 – 00:00 on a Saturday, Sunday, Bank Holiday and public holiday.
3. An eligible person means a person whose principal residence is in the Council's administrative area.
4. An identified vehicle means:
 - a. a vehicle with no more than 9 seats and an unladen weight not exceeding 2450 kg; and
 - b. the holder is either the registered keeper or owner; and
 - c. the registration number recorded on the Council's parking database.
5. A person may be required to provide proof that they are an eligible person and that the vehicle meets the requirements of paragraph 4(a) and 4(b) as the Council may reasonably require.
6. The prescribed fee is £25.00 per annum and a resident permit is valid for 12 months from the date of purchase.
7. A time wheel may only be issued on the first application made by an eligible person. The Council will issue a new time wheel if the time wheel is lost, stolen or damaged on application a holder and payment of a replacement fee of £4.00.
8. A holder who intends to use a resident permit is required to:
 - a. set the time wheel accurately to the time of entry to a parking place at whichever of the following times next follows his actual time of arrival; on the hour, fifteen minutes past the hour, thirty minutes past the hour or forty five minutes past the hour; and
 - b. display the time wheel underneath the front windscreen of the identified vehicle so as to ensure that the time of entry is visible from the outside of the identified vehicle immediately on arrival to a parking place in accordance with paragraph 2 of this Schedule.

9. After the time wheel has been set in accordance with paragraph 8 no person shall alter the indications given by the time wheel while the vehicle remains in the parking place.
10. No person shall display on any vehicle any time wheel which has been altered defaced or damaged or the detail of which are illegible.
11. A resident permit may not be used if it has been used in a parking place in the 2 hours preceding entry to that parking place.
12. If the holder of a resident permit contravenes any part of this Schedule, a parking charge is payable as set out in Schedule 1 and if a ticket is purchased at a ticket machine, it must be displayed in accordance with Article 24.
13. The Council may invalidate a resident permit if it considers that it is not being used in accordance with this Schedule after providing 7 days notice of its intention to the holder of the resident permit.
14. The Council shall be entitled to refuse to issue a resident permit and time wheel to an eligible person who has previously contravened the terms of this Schedule.
15. The holder of a resident permit must notify the Council of a change of an identified vehicle or address either:
 - a) by entering details of the new vehicle using the Council's dedicated parking permit website; or
 - b) by telephone to the dedicated parking number as advertised on the Council's dedicated parking permit websitebefore using the resident permit after such a change of vehicle or address has occurred.
16. The holder of a resident permit must notify the Council if they are no longer an eligible person within 7 days of ceasing to be an eligible person and return to the Council the time wheel.
17. The holder of a resident permit who is no longer an eligible person shall not be entitled to a refund to the resident permit or the cost of the time wheel.

SCHEDULE 3

SEASON TICKETS

1. The Council may issue a virtual season ticket to an eligible person upon payment of a prescribed fee.
2. A season ticket permits an eligible person to park an identified vehicle in a nominated parking place during the permitted hours while the season ticket remains valid.
3. An eligible person means:
 - a. a person who resides in an eligible property as their principal residence; or
 - b. a person who is an employee, temporary worker (with a minimum 3 month contract) partner, proprietor or director of a business operating from an eligible property.
4. An eligible property means a property as indicated in the table below:

Location	Even numbers	Odd numbers	Property name (if applicable)
Malvern			
Abbey Road		11A – 15	
Belle Vue Terrace	2 – 50	37 – 45	
Church Street	8 – 30	5 – 105	
Edith Walk		1 – 3	
Graham Road	4 – 14		
Priory Steps		3 – 11	
St Anne's Road	2 – 6		
Worcester Road	2 – 26	1 – 45	
Tenbury Wells			
Church Street	2 - 26	1 – 23	
Cross Street	8 - 12		
Market Square	2 – 28	1 – 19	
Market Street	2 – 28	1 – 19	
Teme Street	2 – 58	1 – 83	
Upton-upon-Severn			
Church Street	8 – 26		
Court Row			Court Row Lodge Old Chapel
Court Street	2A – 8	1 – 15	
Dunns Lane		7 – 23	
Field Row		1	
High Street	4 - 22	9 – 21	
New Street	2A – 36	1 – 11	1 – 16 Collinghurst House
Old Street	2 – 68	1 – 65	
Waterside			The Boathouse

			Bridgehouse Kings Head The Plough Inn Riverside Cottage Swan Hotel White House
--	--	--	---

5. The nominated parking place means a parking place as indicated in the table below:

Eligible properties	Nominated parking place
Malvern	Brunel House; or Council House; or Priory Road North; or Priory Road South; or Victoria Road;
Tenbury Wells	Teme Street
Upton-upon-Severn	Hanley Road

6. The prescribed fee means the amount payable as indicated in the table below:

Area	Quarterly season ticket	Annual season ticket
Malvern	£40	£120
Tenbury Wells	£40	£120
Upton-upon-Severn	£25	£75

7. A person may be required to provide proof that they are an eligible person as the Council may reasonably require.
8. The Council may refuse to issue a season ticket if it considers that a person is not an eligible person or has reasonable grounds to believe that the season ticket will not be used in accordance with this Schedule.
9. The Council may invalidate a season ticket if it considers that a season ticket is not being used in accordance with this Schedule after providing 7 days notice of its intention to the holder of the season ticket.
10. The holder of a season ticket must notify the Council of a change of vehicle either:
 - a. by entering details of the new vehicle using the Council's dedicated parking permit website; or
 - b. by telephone to the dedicated parking number as advertised on the Council's dedicated parking permit website.
11. The holder of a season ticket must notify the Council if they are no longer an eligible person within 7 days of ceasing to be an eligible person.

12. The holder of a season ticket who no longer is an eligible person shall be entitled to a refund calculated on a pro rata basis for each completed month which the season ticket remains unexpired at the date of notification to the Council.

SCHEDULE 4

CONTRAVENTION CODES

70		Parked in a loading area during restricted hours without reasonable excuse	Higher	Off-street loading areas
71		Parked in an electric vehicles' charging place during restricted hours without charging	Higher	Off-street car parks
73	u	Parked without payment of the parking charge	Lower	Off-street car parks
74	prs	Using a vehicle in a parking place in connection with the sale or offering or exposing for sale of goods when prohibited	Higher	Off-street car parks
77		--- RESERVED FOR DVLA USE ---	n/a	
80	u	Parked for longer than the maximum period permitted	Lower	Off-street car parks
81	o	Parked in a restricted area in a car park	Higher	Off-street car parks
82	puv	Parked after the expiry of paid for time	Lower	Off-street car parks
83		Parked in a car park without clearly displaying a valid pay & display ticket or voucher or parking clock	Lower	Off-street car parks
84	u	Parked with payment made to extend the stay beyond initial time	Lower	Off-street car parks
85	btrw	Parked in a permit bay without clearly displaying a valid permit	Higher	Off-street car parks
86	prs	Not parked correctly within the markings of a bay or space	Lower	Off-street car parks
87		Parked in a designated disabled person's parking place without displaying a valid disabled person's badge in the prescribed manner	Higher	Off-street car parks
89		Vehicle parked exceeds maximum weight or height or length permitted in the area	Higher	Off-street car parks
90	psuv	Re-parked in the same car park within one hour after leaving	Lower	Off-street car parks. "one hour" may be varied to another time period or "the prescribed time period"
91	cg	Parked in a car park or area not designated for that class of vehicle	Higher	Off-street car parks
92	o	Parked causing an obstruction	Higher	Off-street car parks
93		Parked in car park when closed	Lower	Off-street car parks
94	p	Parked in a pay & display car park without clearly displaying two valid pay and display tickets when required	Lower	Off-street car parks. "two" may be varied to another number or "multiple"
95		Parked in a parking place for a purpose other than the designated purpose for the parking place	Lower	Off-street car parks
96	c	Parked with engine running where prohibited	Lower	Off-street car parks - occurs in certain coach bays.

1 - Belle Vue Parking Place

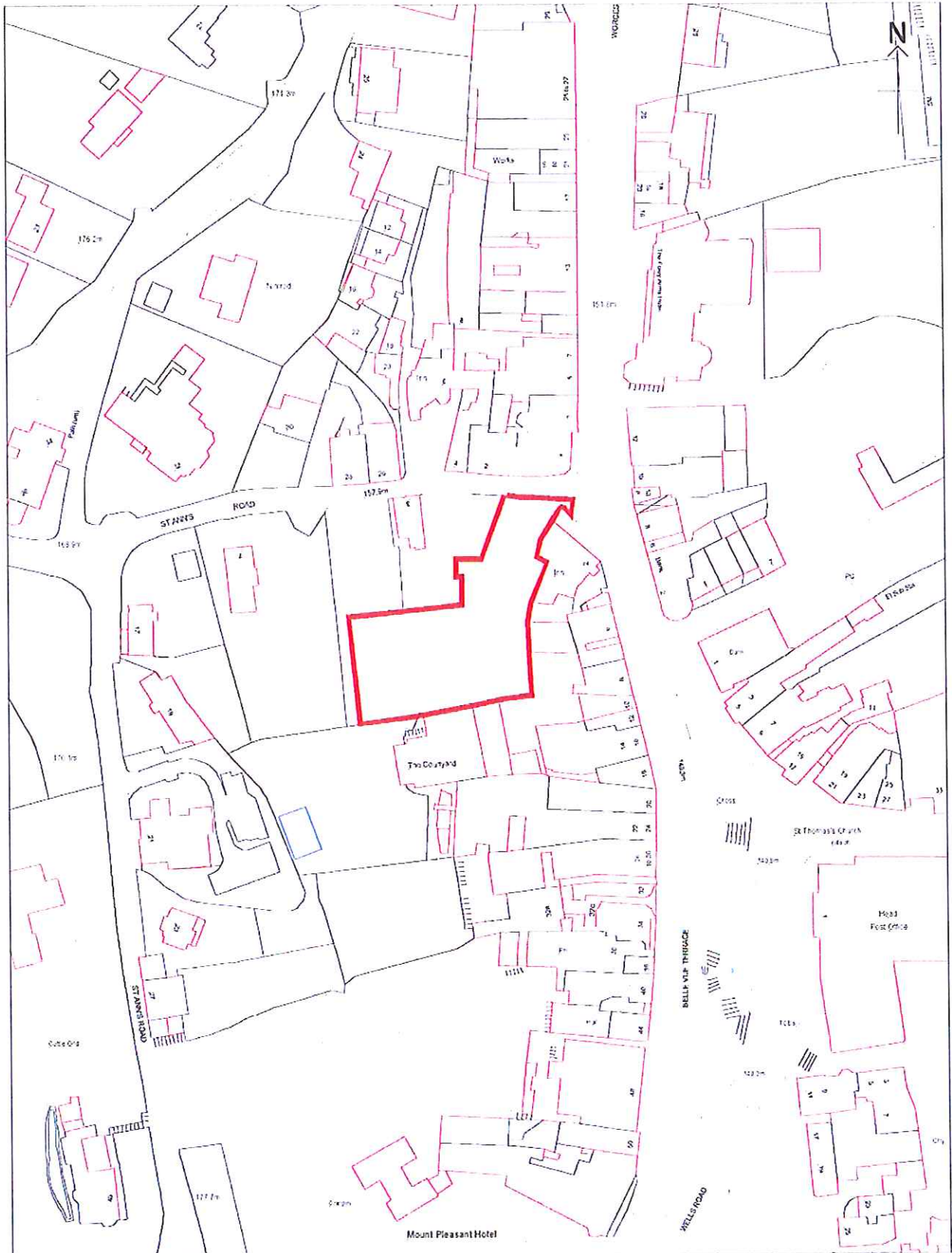

1:1250

2 - Brunel House Parking Place

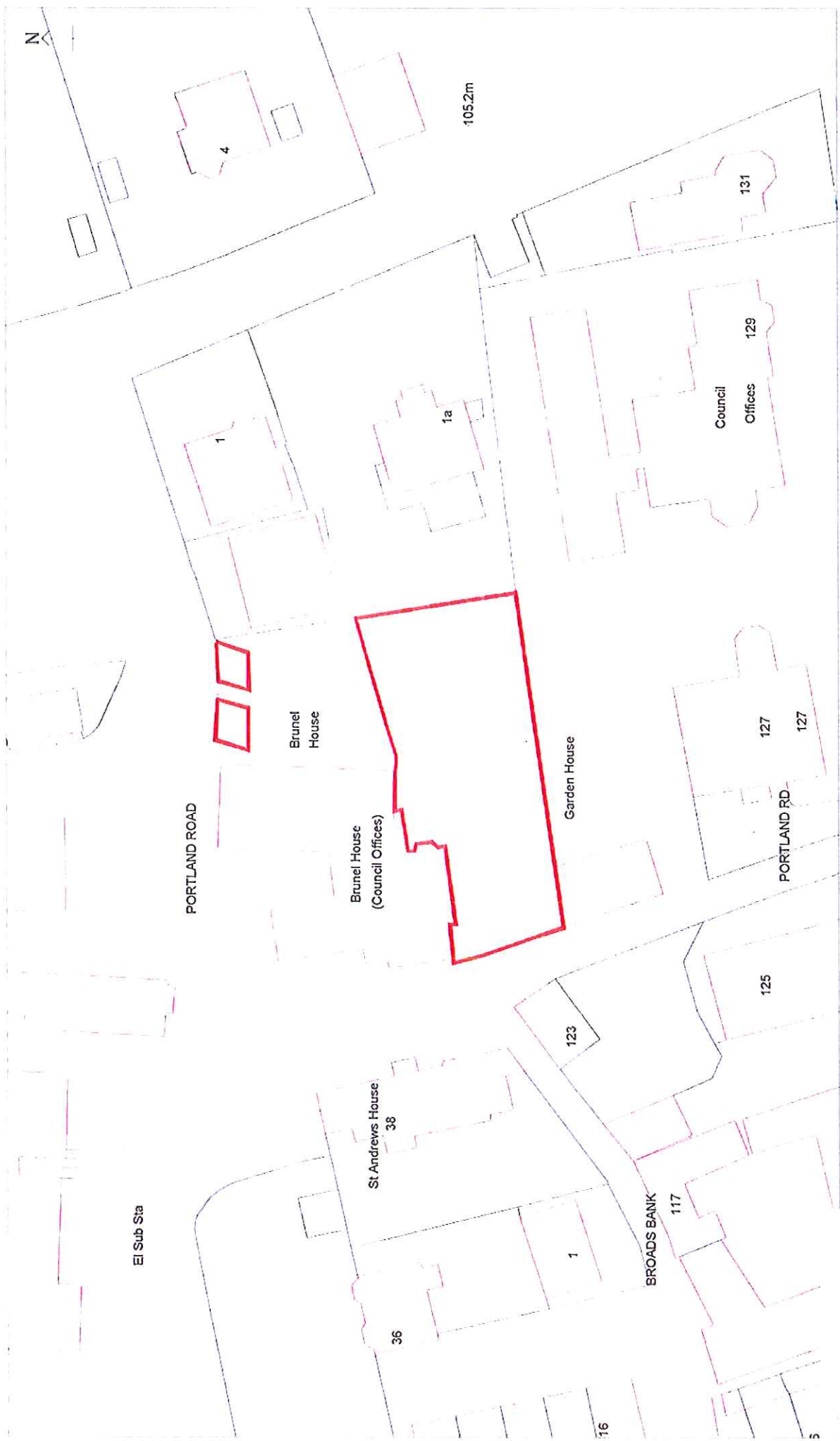

Scale: 1:500

A detailed map of a residential area, likely a school or community center, with a red boundary line. The map includes labels for various buildings and roads. A north arrow is in the top left. Distances are marked along the roads and within the area.

- Shelter**: Located at the bottom left.
- Council Offices**: Multiple locations, including one near the top left and one near the bottom right.
- The Grange**: Located at the bottom right.
- Council House**: Located in the center right.
- Posts**: Located in the center.
- Priory Small Hall**: Located in the center.
- El Sub Sta**: Located near the top center.
- Lawnside Lodge**: Located near the top center.
- VICTORIA ROAD**: Located near the top left.
- AVENUE ROAD**: Located near the top right.

Distances marked:

- 116.1m (along the left boundary)
- 111.6m (along the top boundary)
- 50 (along the top road)
- 56 (along the top road)
- 40 (along the left boundary)
- 36 (along the left boundary)
- 2 (along the top road)
- 4 (along the top road)



Malvern Hills District Council
www.malvern hills.gov.uk

4 - Edith Walk Parking Place

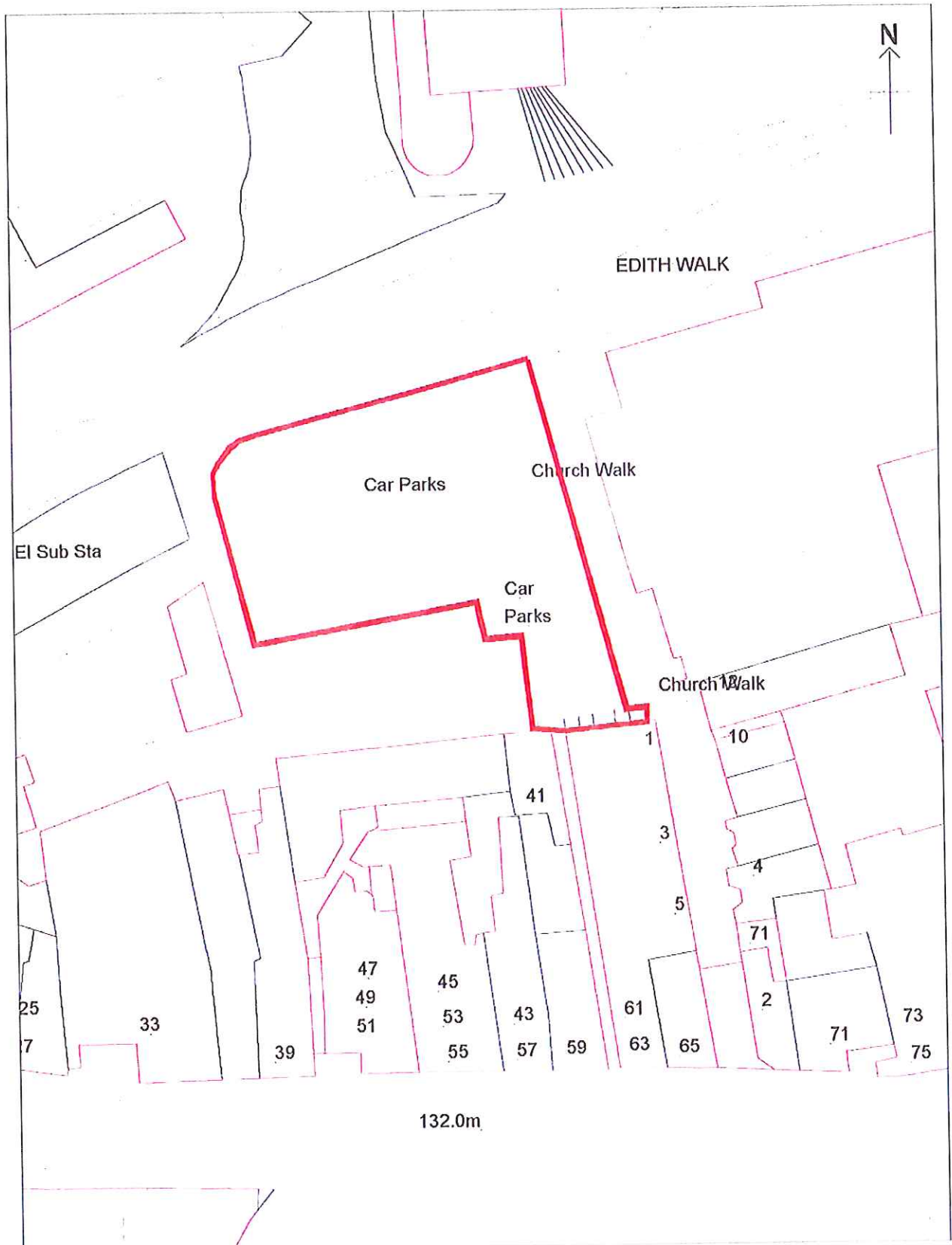

Scale: 1:500

5 - Geraldine Road Parking Place

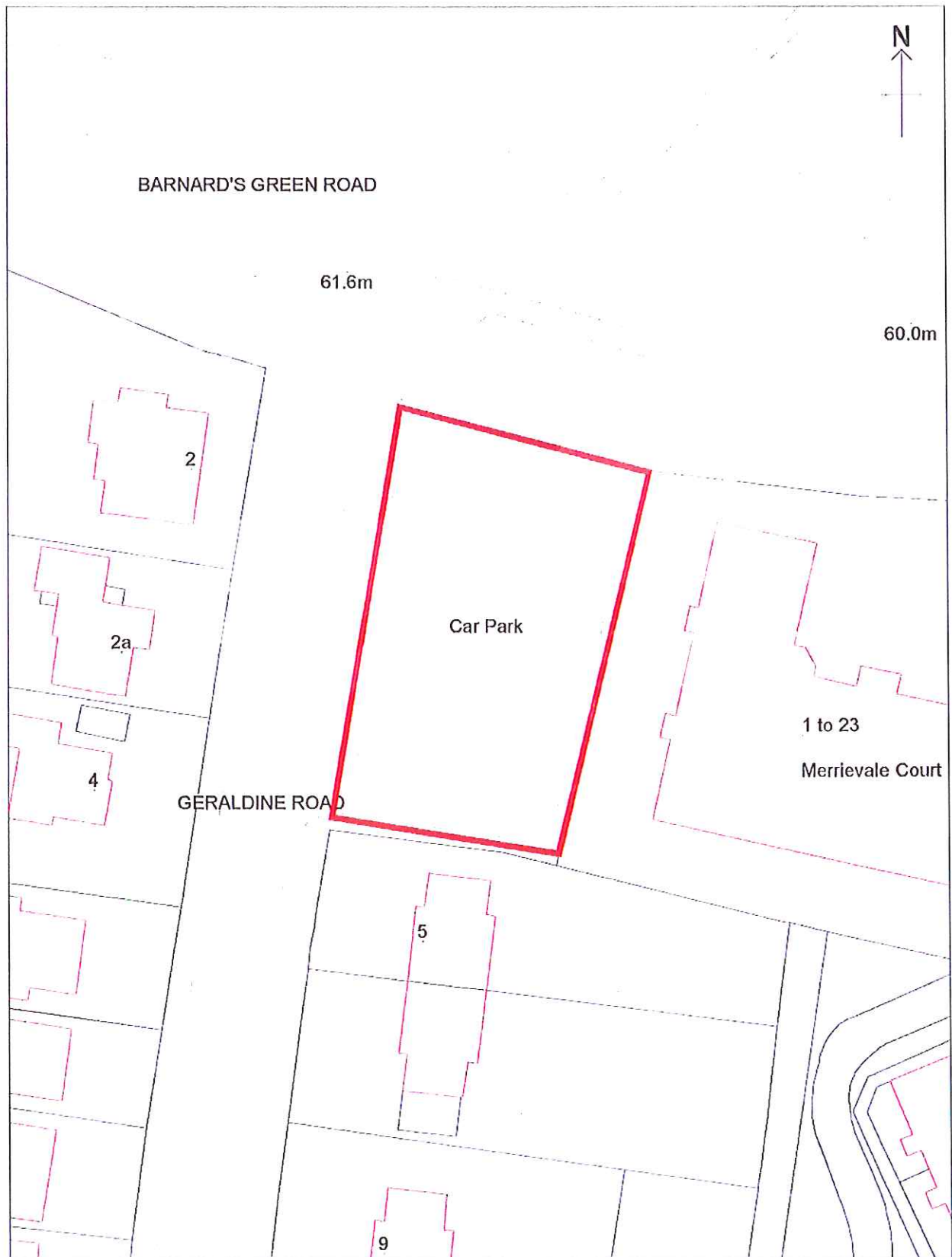

Scale: 1:500

6 - Grange Road North Parking Place

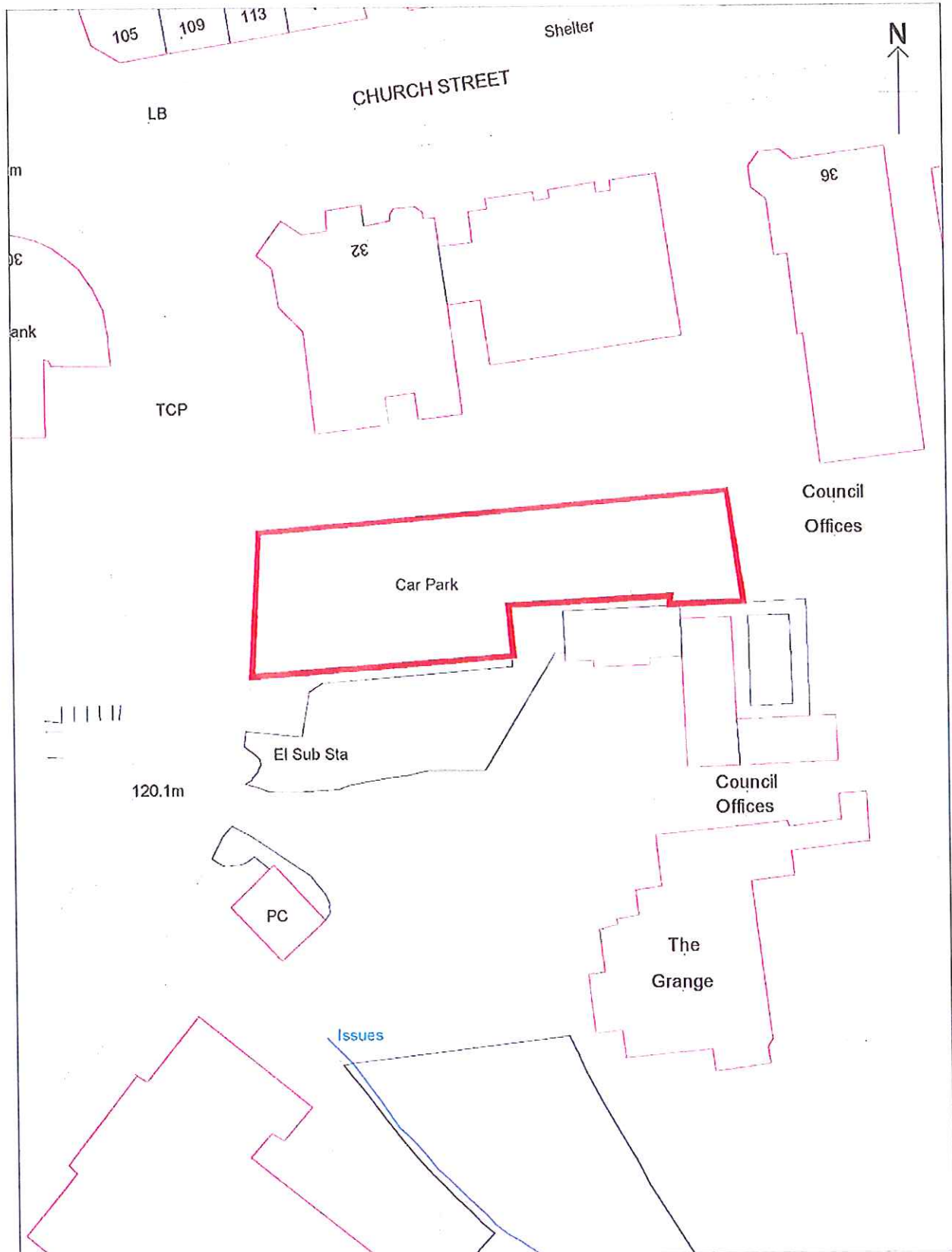

Scale: 1:500

TCP

Car Park

El Sub Sta

120.1m

PC

Council Offices

The Grange

Issues

Festival Theatre

Information Bureau

Sinks

N



Malvern Hills District Council
www.malvernhills.gov.uk

© Crown copyright. All rights reserved
(Malvern Hills District Council) (0100018590) 2013.

8 - Hanley Road, Upton Parking Place

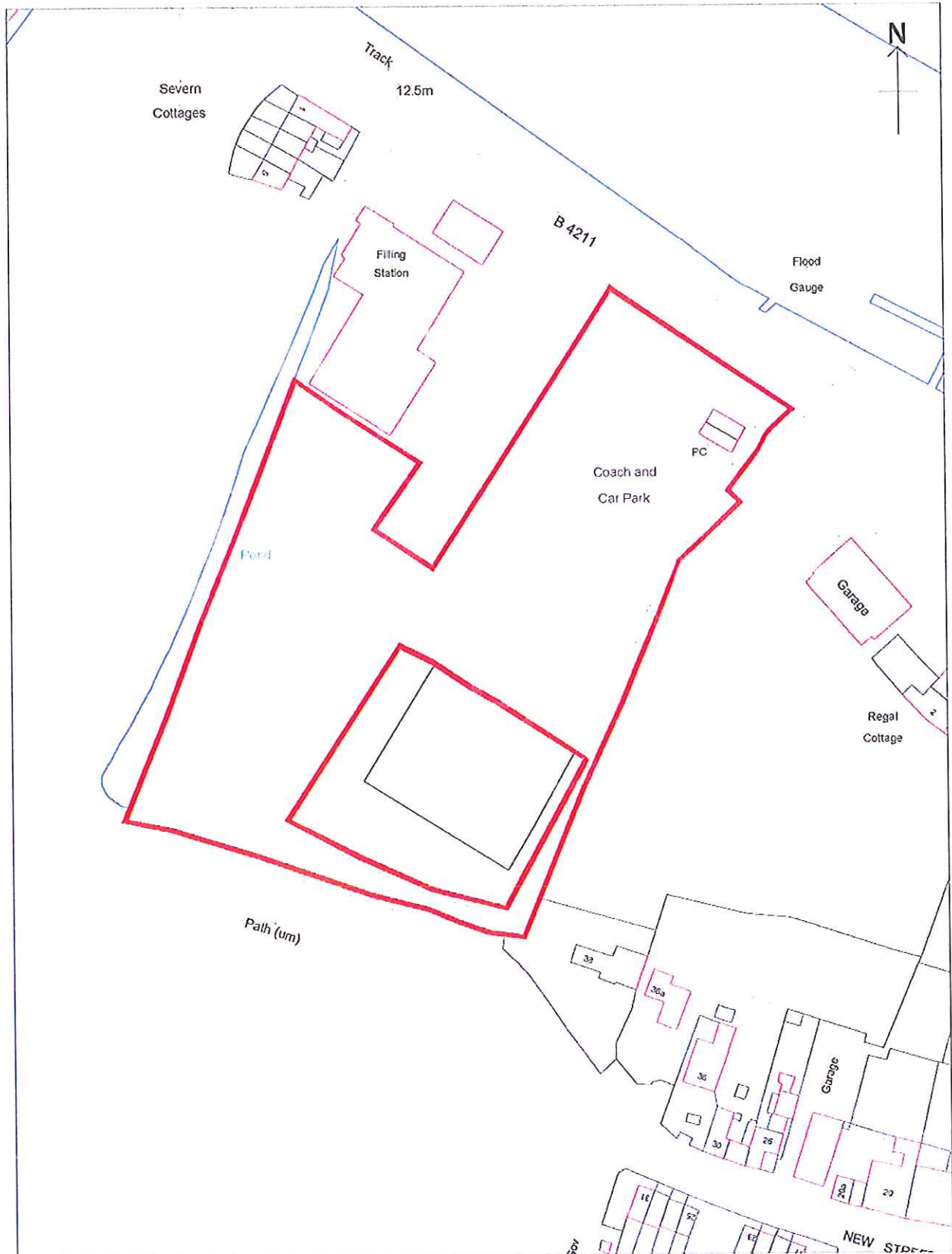

Scale: 1:1250

9 - Link Top Parking Place

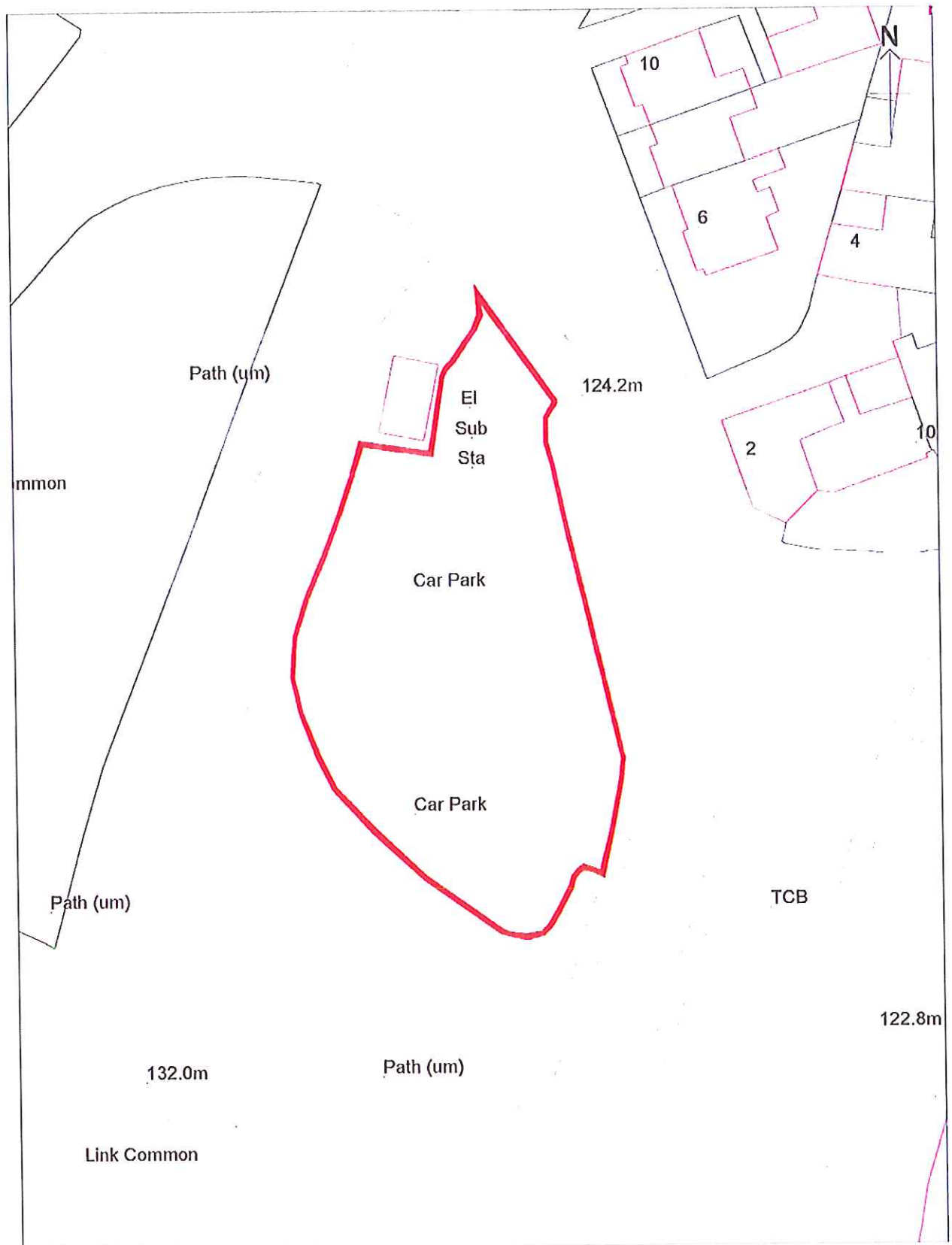

Scale: 1:500

10 - New Street, Upton Parking Place

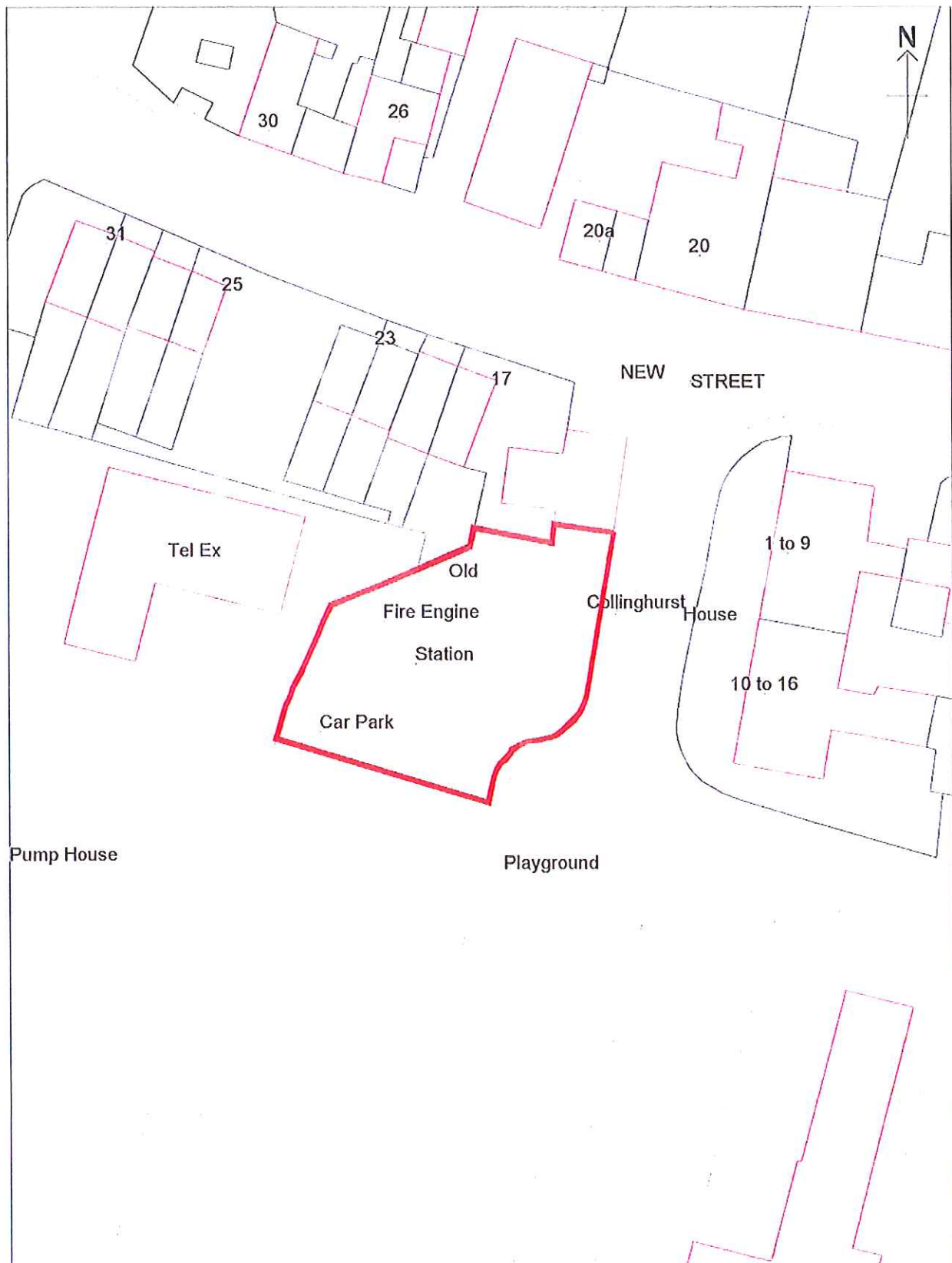

Scale: 1:500

11 - Newtown Road Parking Place

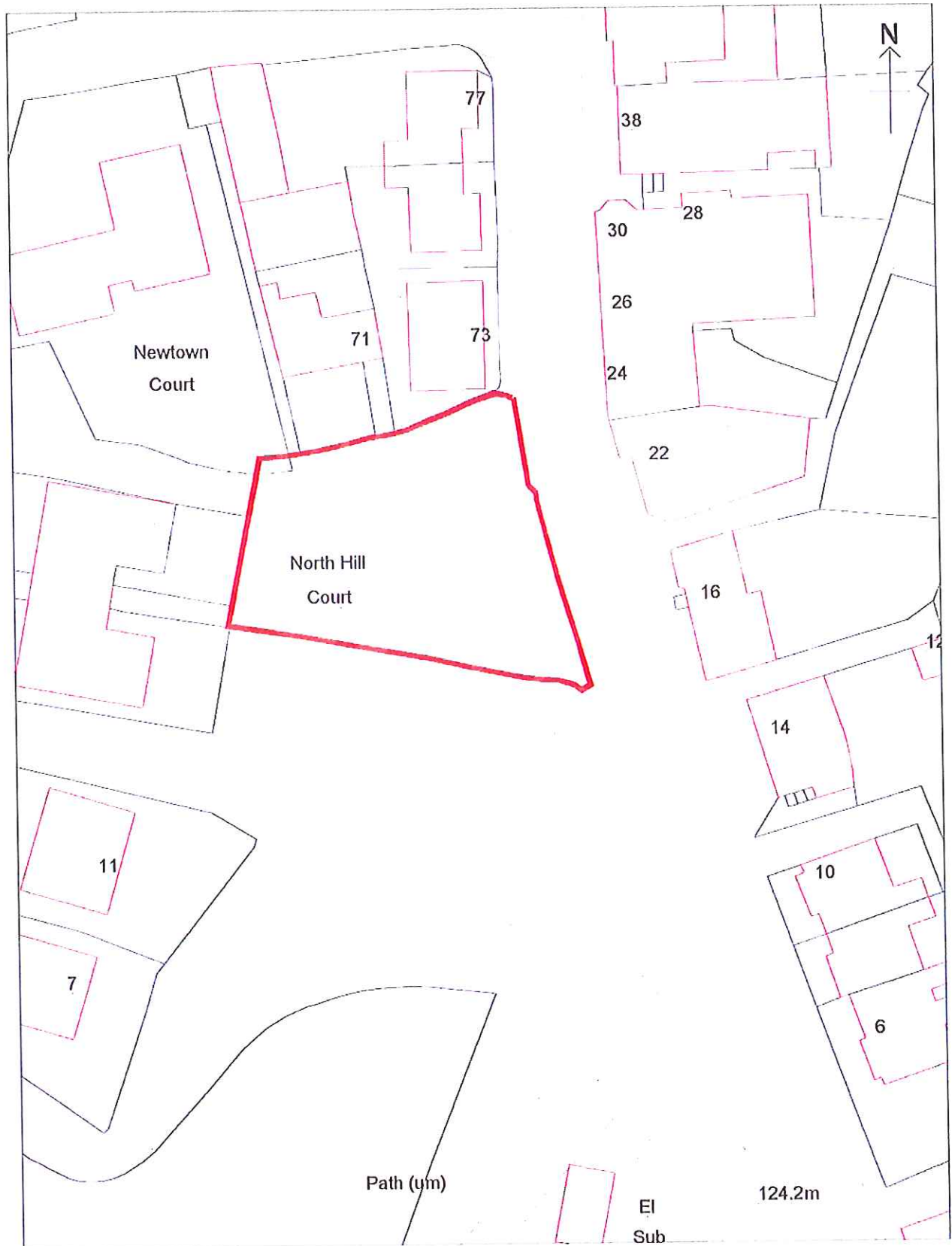

Scale: 1:500

12 - Priory Road North Parking Place

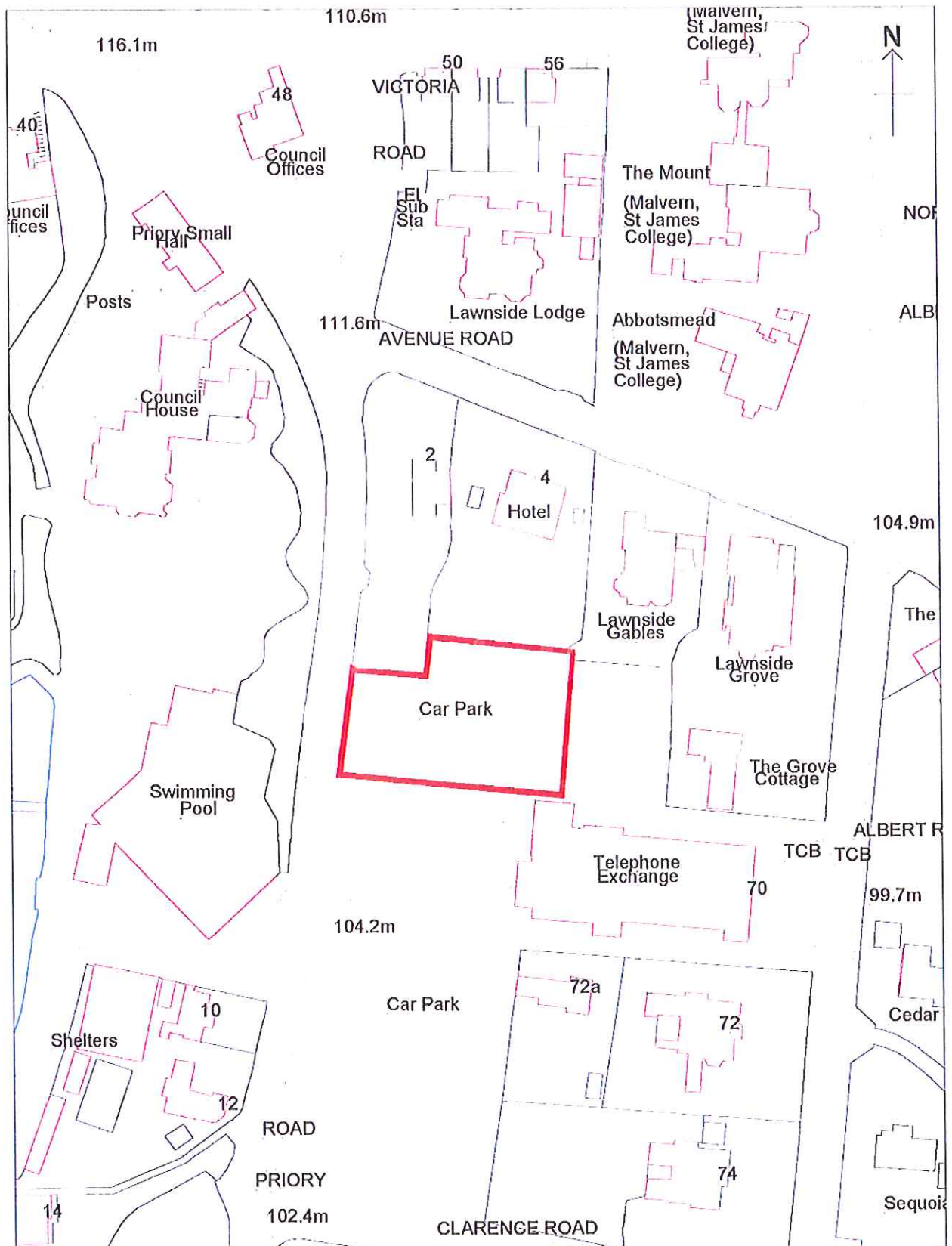

Scale: 1:1250

13 - Priory Road South Parking Place

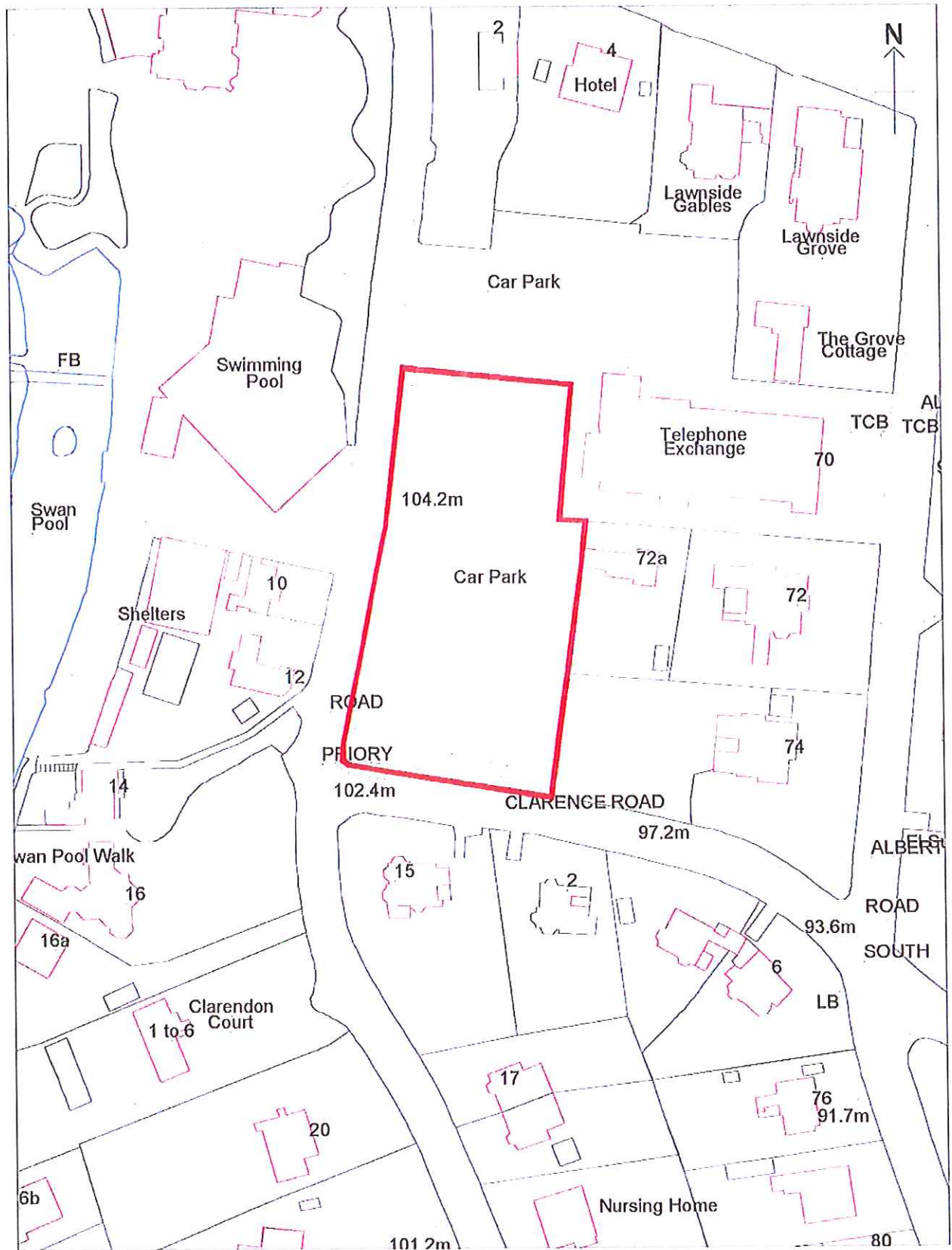

Scale: 1:1250

14 - Teme Street, Tenbury Parking Place

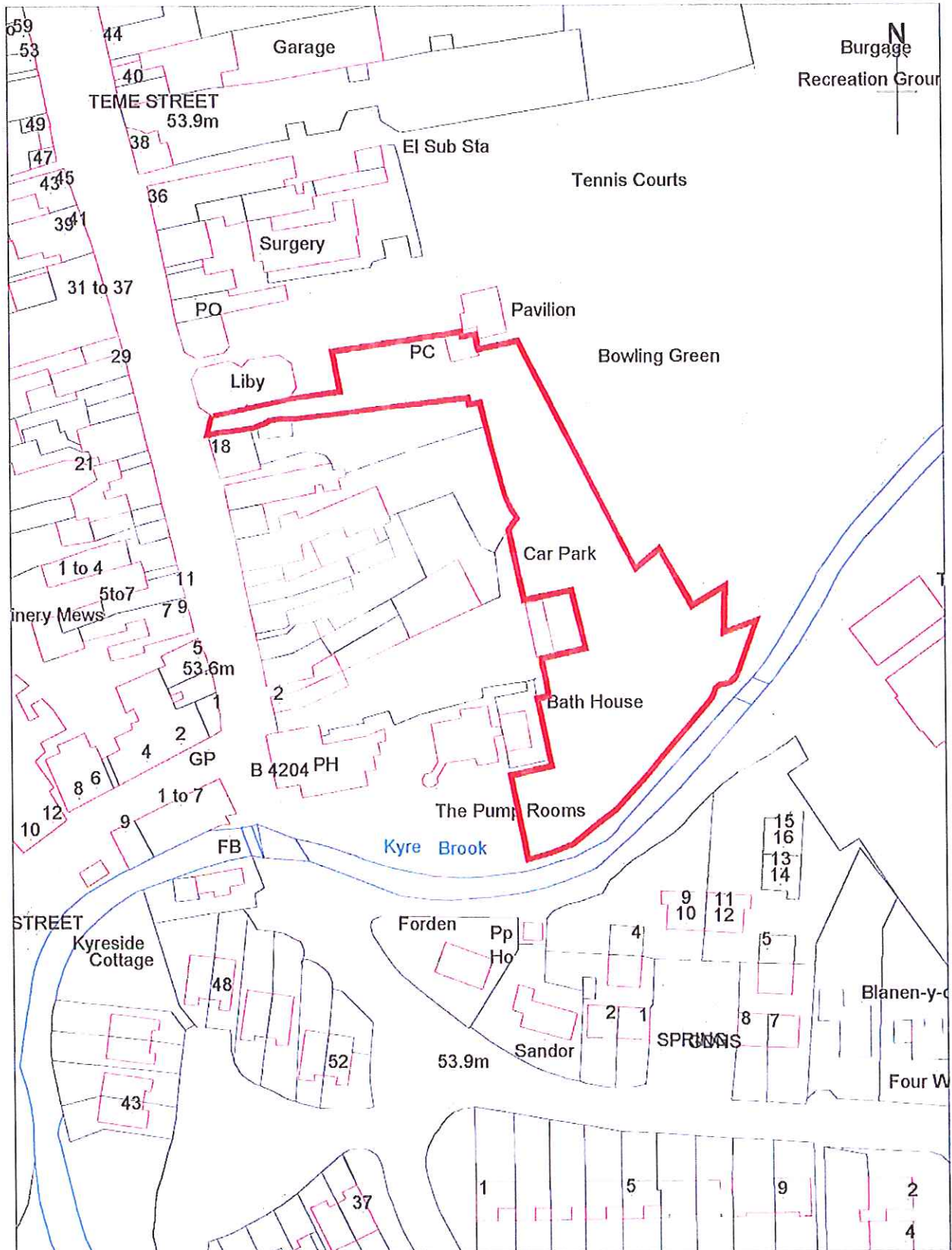

Scale: 1:1250

15 - Victoria Road Parking Place

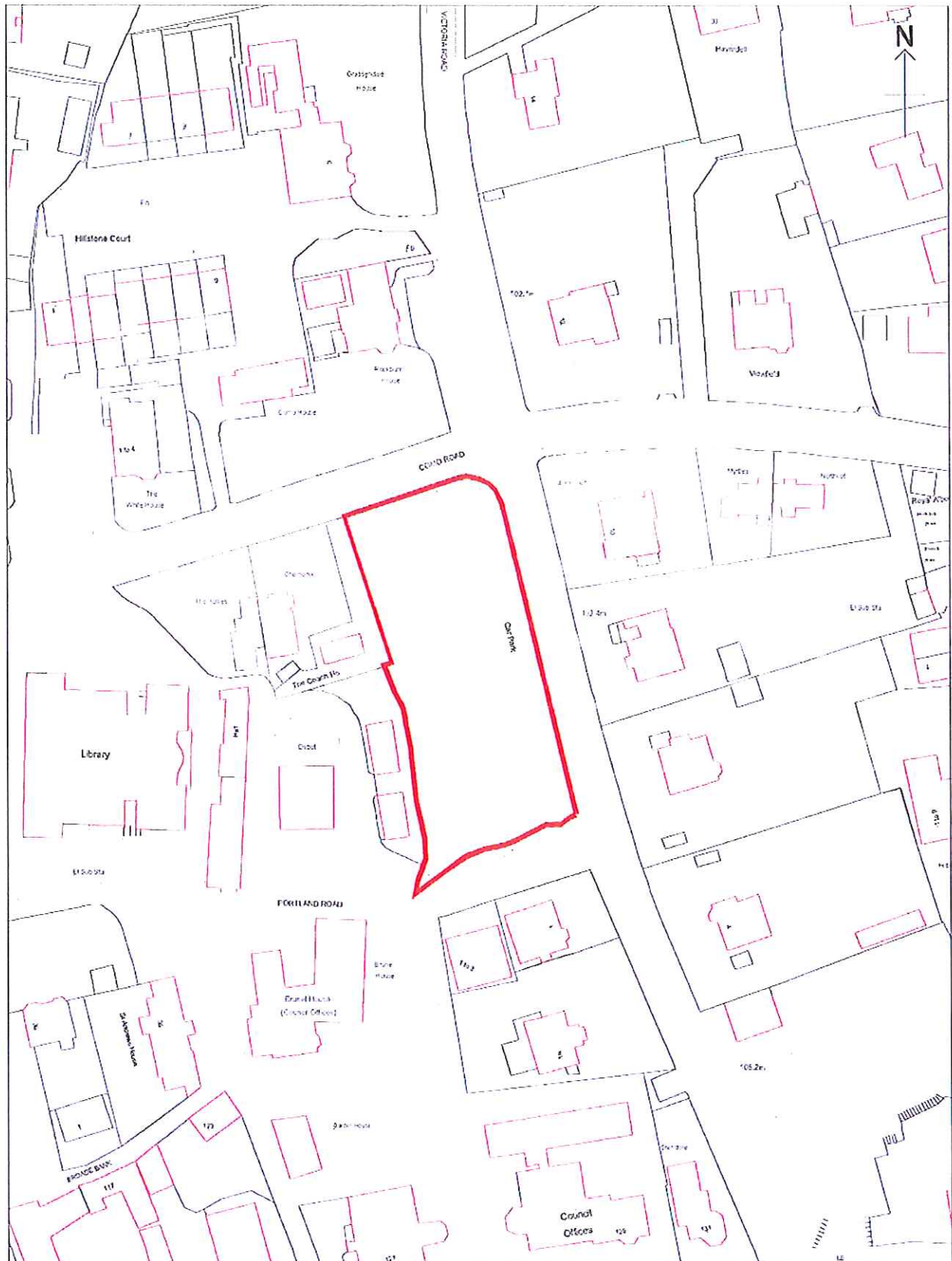

Scale: 1:1250